

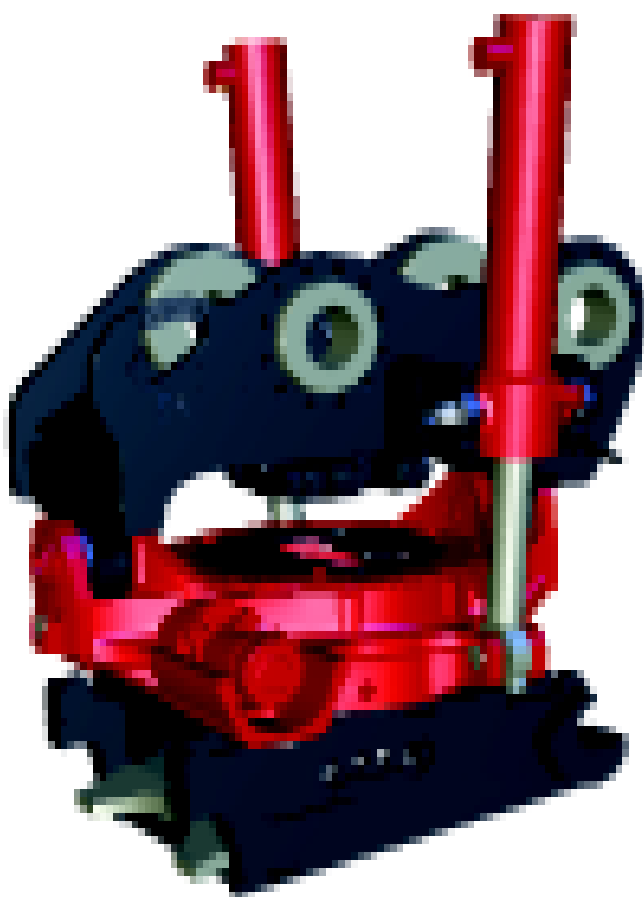

ENG

ROTOTILT RT 60B

Rototilt is designed for excavators with a machine weight of 15 - 24 tonnes



The RT 60B represents a new generation of Rototilt. Built to withstand the extreme stresses and forces to which it is subjected on 15 to 24 tonne excavators.

The new Rototilt RT 60B is a thoroughly tested powerful unit guaranteed to stand up to tough and protracted use.

The RT 60B is equipped with an advanced control system which ensures its versatility for all applications.

- Robust worm drive
- Substantial bearings
- Low overall height
- Compact
- Low weight
- Service-friendly

ROTOTILT

RT 60B

RT 60B - Multi

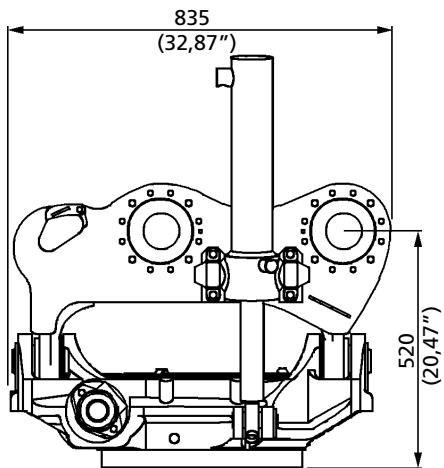

RT 60B - Multi S60

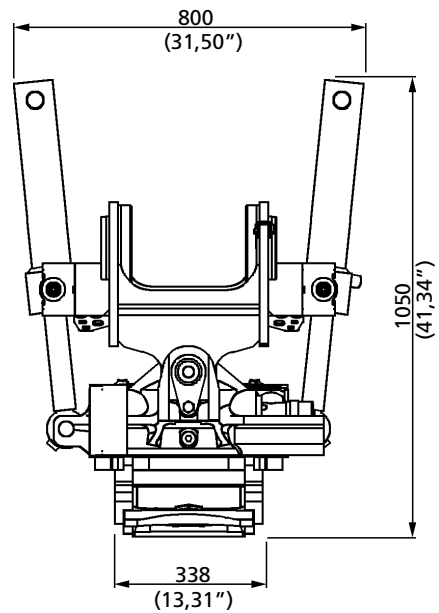
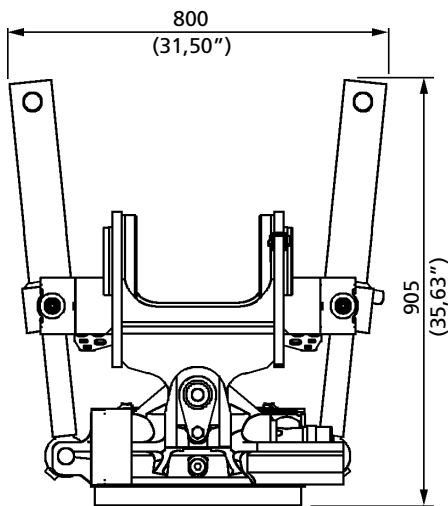
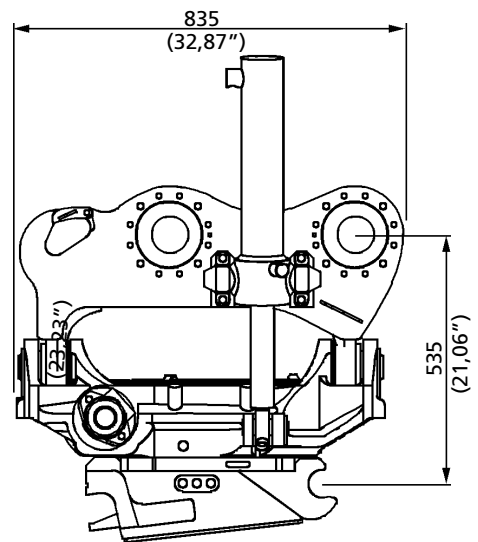

ROTOTILT RT 60B

RT 60B - Multi S70

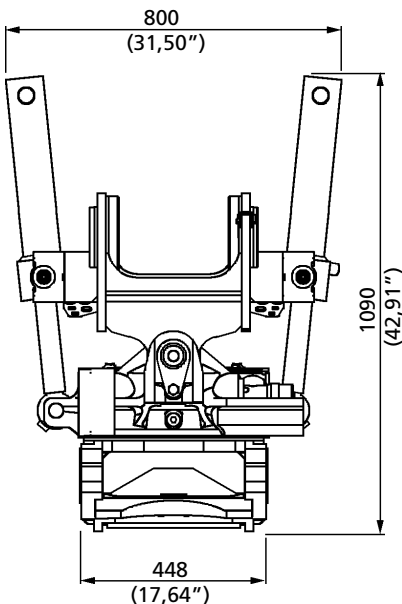
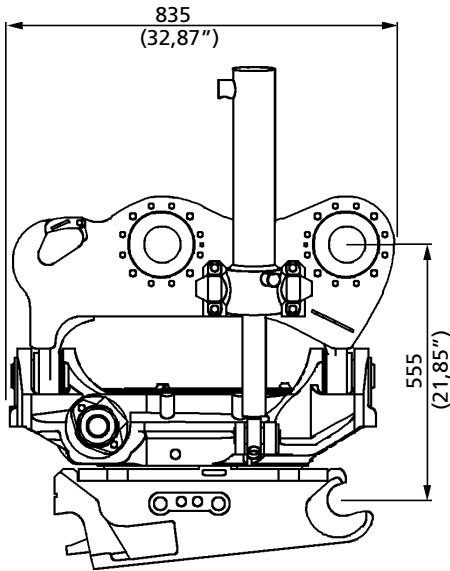

Technical data

<i>Min / Max machine weight (tonne)</i>	15-24
<i>Maximum standard shovel volume (m³)</i>	1,1
<i>Maximum levering torque</i>	170
Weight, kg (lb) ¹⁾	from 415 (915)
Tilting angle	2 x 40°
Tilting torque at 20 MPa, Nm (lb-ft)	35 600 (26 255)
HD (double-acting cylinders) Nm (lb-ft)	45 300 (33 410)
Rotation	unlimited
Rate of rotation (50 l/min)	1 turn / 9 sec
Torque at 20 MPa, Nm (lb-ft)	6 000 (4 425)
Max connecting pressure MPa (psi) ²⁾	35 (5 075)
Working pressure MPa (psi)	20 (2 900)
Max. return lead pressure (50 l/min), MPa (psi)	4 (580)
Min/Max. connected flow, l/min (GPM)	30 / 80 (7,9 / 21,1)

1) = The weight depends of the type of fastening, mount and control system. For the exact weight see the rating plate

2) = Connection hydraulic motor-control system TE max. 20 MPa (2900 psi).

A combination of various stated limits of the machine like total weight, bucket volume, bending force etc. all together creates the conditions of what size of RT should be chosen. If a machine exceeds any of the stated limits, please consult your supplier in order to investigate the specific case. Environmental causes, or the type of job/use could sometimes be of decisive importance.